

# Technical Data Sheet

CODE 17009

## VORTICE LINEO 250 V0

In-line mixed flow fans



### Certifications



IMQ



CE



IMQ Performance



C Tick Mark



CCC



EAC

### TECHNICAL AND PERFORMANCE DATA

|   |         |   |       |
|---|---------|---|-------|
| Absorbed power 1st speed (W)                          | 110     | Delivery 1st speed (l/s)                        | 275   |
| Absorbed Power max (W)                                | 180     | Delivery 1st speed (m <sup>3</sup> /h)          | 990   |
| Frequency (Hz)  | 50      | Max delivery at max speed (l/s)                 | 375   |
| Insulation Class                                      | II°     | Max delivery at max speed (m <sup>3</sup> /h)   | 1350  |
| IP  | 44      | Pressure - 1st speed (mmH2O)                    | 36    |
| Max ambient temperature for continuous operation (°C) | 60      | Pressure - 1st speed (Pa)                       | 353,2 |
| Max. absorbed Current at max. speed (A)               | 0,78    | Pressure max - max speed (mmH2O)                | 53    |
| Max. absorbed Current at min. speed (A)               | 0,48    | Pressure max - max speed (Pa)                   | 519,9 |
| Max. absorbed power at max speed (W)                  | 180     | RPM max   | 2550  |
| Voltage (V)   | 220-240 | RPM min   | 1900  |
| Weight (Kg)   | 7       | Sound pressure level Lp [dB (A)] 3m - max speed | 59,1  |
|   |         | Sound pressure level Lp [dB (A)] 3m - min speed | 51,4  |

### DIMENSIONS

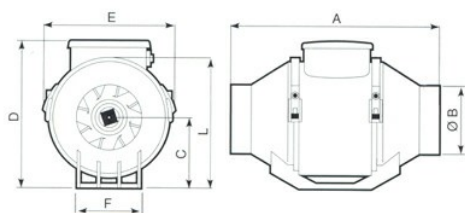

|             |       |
|-------------|-------|
| Size A (mm) | 300   |
| Size B (mm) | 317   |
| Size C (mm) | 385   |
| Size D (mm) | 247   |
| Size E (mm) | 152,5 |
| Size F (mm) | 292   |
| Size G (mm) | 176,5 |
| Size H (mm) | 140   |
| Size L (mm) | 145   |
| Size M (mm) | 8     |

#### PER INFORMAZIONI:

Servizio al Cliente: tel +39 02 90699395 premendo 1 dopo messaggio registrato (consulenza su prodotti e impianti)

Pre & Post Vendita: fax +39 02 90699302

Email prevendita: [prevendita@vortice-italy.com](mailto:prevendita@vortice-italy.com)

# Technical Data Sheet

CODE 17009

## VORTICE LINEO 250 V0

In-line mixed flow fans



### DESCRIPTION

- Material: self-extinguishing plastic resin (self-extinguishing capability V0)
- Nominal diameter 250 mm.
- 2 speed AC motor with thermal overload cutout and shaft turning in ball bearings, coupled to mixed flow axial-centrifugal impeller.
- Minimum air flow 990 m<sup>3</sup>/h
- Maximum air flow: 1350 m<sup>3</sup>/h
- IMQ SAFETY and IMQ PERFORMANCE certifications
- Vortice speed controllers.

### CURVES

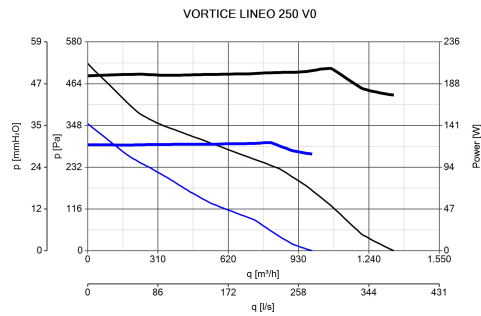

### ACCESSORIES

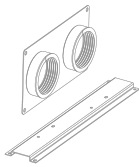

**LINEO-PF 250**  
Code 22583



**LINEO-C 250**  
Code 22589

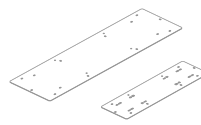

**LINEO-SF 700**  
Code 22594

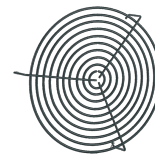

**LINEO-G 250**  
Code 22706

#### PER INFORMAZIONI:

Servizio al Cliente: tel +39 02 90699395 premendo 1 dopo messaggio registrato (consulenza su prodotti e impianti)  
Pre & Post Vendita: fax +39 02 90699302  
Email prevendita: [prevendita@vortice-italy.com](mailto:prevendita@vortice-italy.com)